



# WASHER/DRYER AND SINK COMBO

Whether you have a small condo where space is a precious resource, or you have a large home with a separate space for a laundry room, not many people consider how to incorporate them all using kitchen cabinets. This is a simple design that can easily be scaled into a full laundry room, or laid out to incorporate a tiny studio apartment kitchen. With the popularity of stackable washer/dryer combos on the rise, this is an easy way to incorporate them into any room.

## Supplies You Will Need from the RTA Cabinet Store

- ✓ One 24" wide x 84" high pantry (this could be taller depending on the size of your washer/dryer stack)
- ✓ One 30" wide x 15" high wall cabinet (this will vary based on the width and height of your washer/dryer unit)
- ✓ One 84" refrigerator panel
- ✓ One 9" base cabinet
- ✓ One 30" sink base cabinet
- ✓ One 15" drawer base cabinet
- ✓ Two pieces of 8' crown molding
- ✓ (optional) consider the Rev-a-Shelf pull out spice rack insert for the base cabinet next to the washer and dryer as an easy way to store all of your laundry supplies
- ✓ (optional) one 8' length of toe kick to make a seamless line across the front
- ✓ (optional) decorative base end panel

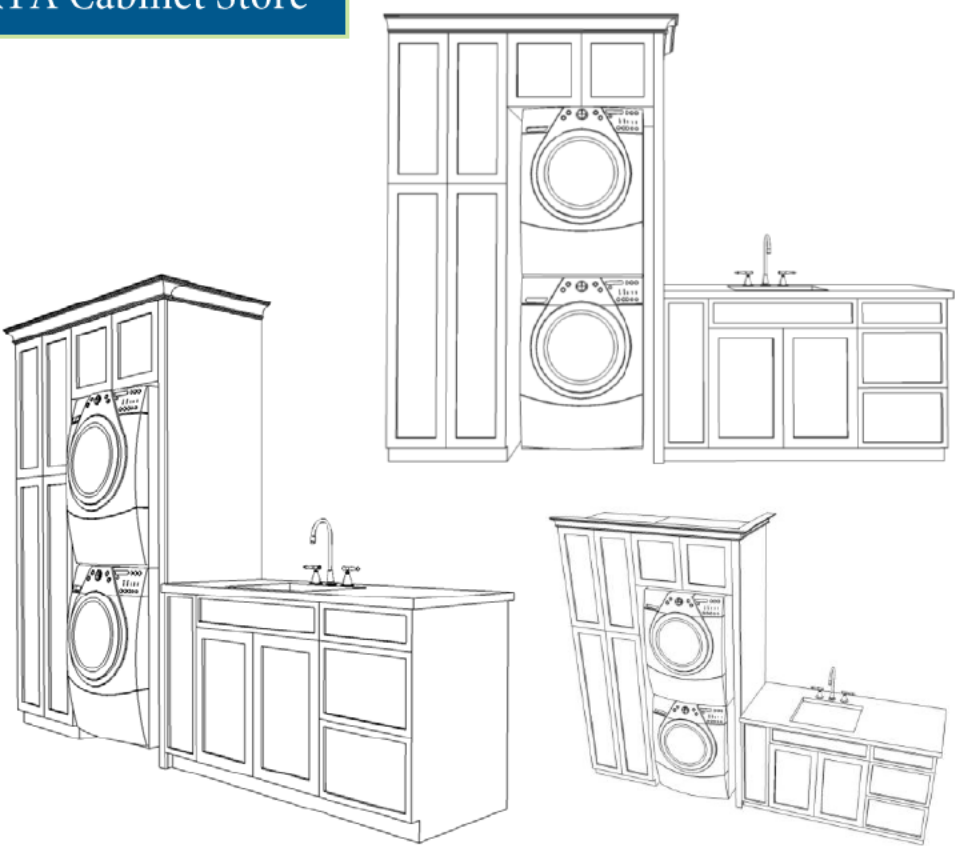

[www.rtacabinetstore.com](http://www.rtacabinetstore.com)

P. 610-337-5934 F. 484-231-8726

## Instructions to Build a Washer/Dryer and Sink Combo

Step 1: Install the pantry, securing it to the wall.

Step 2: Depending on what size wall cabinet you went with, you will need to bring this cabinet out to line up with the face frame of the pantry. You can either build a frame behind it, to secure to the wall, or you can secure the cabinet to face frame and side of the pantry, and to the refrigerator panel which will be attaching to it on the other side.

Step 3: Install the refrigerator panel, attaching it to the upper wall cabinet. This will also be secured to the adjacent base cabinet in the next step.

Step 4: Install the base cabinets, securing them to both the wall and to each other at the face frame. Also secure the refrigerator panel to the closest base cabinet.

Step 5: Using a miter saw or compound miter saw, cut the crown molding to length. Be sure to make mitered cuts on the corners for a professional look.

Step 6: Add the optional toe kick to the bottom, and decorative end panel to the side for a more finished look.

## My Design Notes