

Doors and Drawers will have a distressed look to them - knots and other characteristics may be visible. Please order a Sample Door before ordering if you are unsure of what this means

30 " HGT. SINGLE DOOR WALL CABINETS



W0930	9" x 30" Single Door	
	Height of Opening	26-7/8"
	Width of Opening	5-7/8"
W1230	12" x 30" Single Door	
	Height of Opening	26-7/8"
	Width of Opening	8-7/8"
W1530	15" x 30" Single Door	
	Height of Opening	26-7/8"
	Width of Opening	11-7/8"
W1830	18" x 30" Single Door	
	Height of Opening	26-7/8"
	Width of Opening	14-7/8"
W2130	21" x 30" Single Door	
	Height of Opening	26-7/8"
	Width of Opening	17-7/8"
	Interior Depth	10-3/4"

30 " HGT. DOUBLE DOOR WALL CABINETS

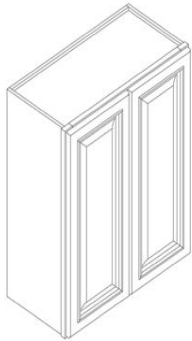

W2430	24" x 30" Double Door	
	Height of Opening	26-7/8"
	Width of Opening	9-5/8"
W2730	27" x 30" Double Door	
	Height of Opening	26-7/8"
	Width of Opening	11-1/8"
W3030	30" x 30" Double Door	
	Height of Opening	26-7/8"
	Width of Opening	12-5/8"
W3630	36" x 30" Double Door	
	Height of Opening	26-7/8"
	Width of Opening	15-5/8"
	Interior Depth	10-3/4"

42 " HGT. SINGLE DOOR WALL CABINETS

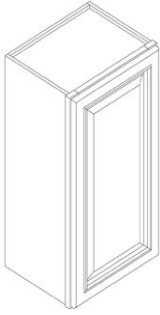

W0942	9" x 42" Single Door	
	Height of Opening	38-7/8"
	Width of Opening	5-7/8"
W1242	12" x 42" Single Door	
	Height of Opening	38-7/8"
	Width of Opening	8-7/8"
W1542	15" x 42" Single Door	
	Height of Opening	38-7/8"
	Width of Opening	11-7/8"
W1842	18" x 42" Single Door	
	Height of Opening	38-7/8"
	Width of Opening	14-7/8"
W2142	21" x 42" Single Door	
	Height of Opening	38-7/8"
	Width of Opening	17-7/8"
	Interior Depth	10-3/4"

42 " HGT. DOUBLE DOOR WALL CABINETS

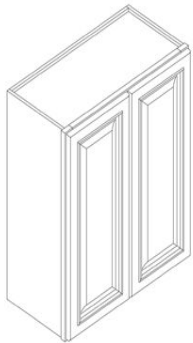

W2442	24" x 42" Double Door / Availability	
	Height of Opening	38-7/8"
	Width of Opening	9-5/8"
W2742	27" x 42" Double Door / Availability	
	Height of Opening	38-7/8"
	Width of Opening	11-1/8"
W3042	30" x 42" Double Door / Availability	
	Height of Opening	38-7/8"
	Width of Opening	12-5/8"
W3642	36" x 42" Double Door / Availability	
	Height of Opening	38-7/8"
	Width of Opening	15-5/8"
	Interior Depth	10-3/4"

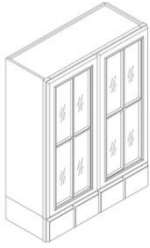
42" HGT. DBLE. DR. WALL CAB.W/ GLASS INSERT

W3042GD4	30" x 42" @ Glass Doors, w/ 4 drawers / Availability	
	Height of Opening	32-13/16"
	Width of Opening	12-5/8"
	Interior Depth	10-3/4"
W3642GD6	36" x 42" @ Glass Doors, w/ 6 drawers / Availability	
	Height of Opening	32-13/16"
	Width of Opening	15-5/8"
	Interior Depth	10-3/4"

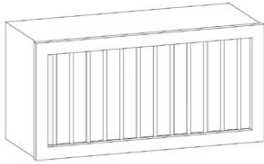
PLATE HOLDER WALL CABINETS

W3015PL	30" x 15" Plate Holder	
	Number of Plate Slots	13
	Height of Opening	11-13/16"
	Width of Opening	26-7/8"
	Interior Depth	10-3/4"
W3615PL	36" x 15" Plate Holder	
	Number of Plate Slots	15
	Height of Opening	11-13/16"
	Width of Opening	32-7/8"
	Interior Depth	10-3/4"

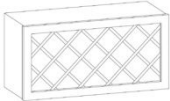
WINE BOTTLE RACK WALL CABINETS

W3015WR	30" x 15" Wine Bottle Rack	
	Number of Bottle Slots	13
W3615WR	36" x 15" Wine Bottle Rack	
	Number of Bottle Slots	17

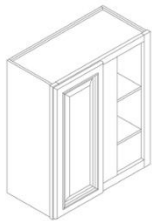
30" HGT. CORNER WALL CABINETS

W2430DC	24" x 30" Diagonal Corner	
	Height of Opening	26-7/8"
	Width of Opening	13-3/4"
	Interior Depth	17-3/4"
W2730BC	27" X 30" Blind Corner	
	Height of Opening	26-7/8"
	Width of Opening	12-5/8"
	Interior Depth	10-3/4"

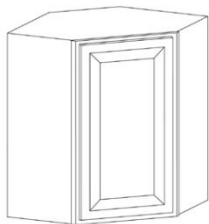
42" HGT. CORNER WALL CABINETS

W2442DC	24" X 42" Diagonal Corner	
	Height of Opening	38-7/8"
	Width of Opening	13-3/4"
	Interior Depth	17-3/4"
W2742BC	27" X 42" Blind Corner	
	Height of Opening	38-7/8"
	Width of Opening	12-5/8"
	Interior Depth	10-3/4"

BRIDGE CABINETS

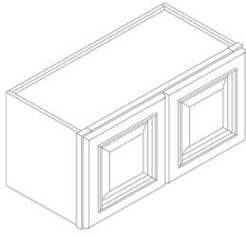

W3012	30" x 12" Double Door	
	Height of Opening	8-7/8"
	Width of Opening	12-5/8"
W3612	36" x 12" Double Door	
	Height of Opening	8-7/8"
	Width of Opening	15-5/8"
W3015	30" x 15" Double Door	
	Height of Opening	11-13/16"
	Width of Opening	12-5/8"
W3315	33" x 15" Double Door	
	Height of Opening	11-13/16"
	Width of Opening	14-1/8"
W3615	36" x 15" Double Door	
	Height of Opening	11-13/16"
	Width of Opening	15-5/8"
W3018	30" x 18" Double Door	
	Height of Opening	14-7/8"
	Width of Opening	12-5/8"
W3024	30" x 24"H x 12"D Double Door	
	Height of Opening	20-7/8"
	Width of Opening	12-5/8"
W3624	36" x 24"H x 12"D Double Door	
	Height of Opening	20-7/8"
	Width of Opening	15-5/8"
W3024-24	Refrig. Cabinet 30"Wx24"Hx24"D Double Door	
	Height of Opening	20-7/8"
	Width of Opening	12-5/8"
W3615-24	Refrig. Cabinet 36"Wx15"Hx24"D Double Door	
	Height of Opening	11-13/16"
	Width of Opening	15-5/8"
	Interior Depth	10-3/4"

SGL. DOOR BASE CABINETS

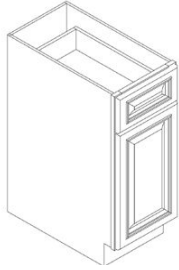

B09	9" Base for trays (Full Height door)	
	Height of Opening	26-7/8"
	Width of Opening	5-7/8"
	Interior Depth	22-3/4"
B12	12" Single Door / Single Drawer	
	Interior Drawer Width	7-1/4"
	Interior Drawer Height	3-1/4"
	Height of Opening	20-1/8"
	Width of Opening	8-7/8"
	Interior Depth	22-3/4"
B15	15" Single Door / Single Drawer	
	Interior Drawer Width	10-1/4"
	Interior Drawer Height	3-1/4"
	Height of Opening	20-1/8"
	Width of Opening	11-7/8"
	Interior Depth	22-3/4"
B18	18" Single Door / Single Drawer	
	Interior Drawer Width	13-1/4"
	Interior Drawer Height	3-1/4"
	Height of Opening	20-1/8"
	Width of Opening	14-7/8"
	Interior Depth	22-3/4"
B21	21" Single Door / Single Drawer	
	Interior Drawer Width	16-1/4"
	Interior Drawer Height	3-1/4"
	Height of Opening	20-1/8"
	Width of Opening	17-7/8"
	Interior Depth	22-3/4"

CORNER BASE CABINETS

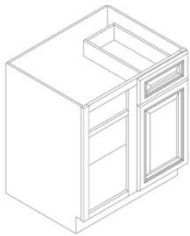

CBB36BC	36" Blind Corner Single Door / Single Drawer 36" Unit, Must be pulled to 42"	
	*Note: The Blind Corner requires 6" offset from the wall, rough in 42" total	
	Interior Drawer Width	14
	Interior Drawer Height	3-1/4"
	Width of Opening	15-5/8"
	Interior Depth	22-3/4"
CBB36DC	36" Diagonal Corner w/Lazy Susan	
	Diameter of Susan Shelf	27-1/2"

DBLE. DOOR BASE CABINETS

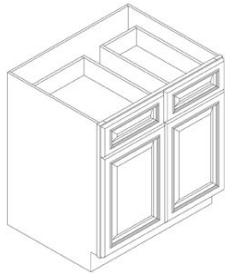

B24	24" Double Door / Single Drawer	
	Interior Drawer Width	19-1/4"
	Interior Drawer Height	3-1/4"
	Height of Opening	20-1/8"
	Width of Opening	9-5/8"
	Interior Depth	22-3/4"
B27	27" Double Door / Single Drawer	
	Interior Drawer Width	22-1/4"
	Interior Drawer Height	3-1/4"
	Width of Opening	11-1/8"
	Interior Depth	22-3/4"
B30	30" Double Door / Single Drawer	
	Interior Drawers Width	25-1/4"
	Interior Drawers Height	3-1/4"
	Height of Opening	20-1/8"
	Width of Opening	12-5/8"
	Interior Depth	22-3/4"
B36	36" Double Door / Two Drawers	
	Interior Drawers Width	14
	Height of Opening	20-1/8"
	Width of Opening	15-5/8"
	Interior Depth	22-3/4"

DRAWER BANK BASE CABINETS

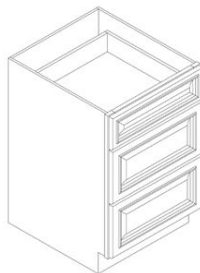

B15D	15" Drawer Unit / (3) Drawers	
	Interior Drawer "A" Width / Quantity (1)	10-1/4"
	Interior Drawers Height	3-1/4"
	Interior Drawer "B" Width / Quantity (2)	10-1/4"
	Interior Drawers Height	7-1/2"
B18D	18" Drawer Unit / (3) Drawers	
	Interior Drawer "A" Width / Quantity (1)	13-1/4"
	Interior Drawers Height	3-1/4"
	Interior Drawer "B" Width / Quantity (2)	13-1/4"
	Interior Drawers Height	7-1/2"
B24D	24" Drawer Unit / (3) Drawers	
	Interior Drawer "A" Width / Quantity (1)	19-1/4"
	Interior Drawers Height	3-1/4"
	Interior Drawer "B" Width / Quantity (2)	19-1/4"
	Interior Drawers Height	7-1/2"
B30D	30" Drawer Unit / (3) Drawers	
	Interior Drawer "A" Width / Quantity (1)	25-1/4"
	Interior Drawers Height	3-1/4"
	Interior Drawer "B" Width / Quantity (2)	25-1/4"
	Interior Drawers Height	7-1/2"

84" HGT. PANTRY W ADJST. SHELVES

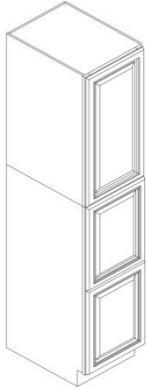

P1884 18" x 84" Pantry Two Doors (Two Separate Stacked Units)

Height of Opening (Top Unit)	32-7/8"
Width of Opening (Top Unit)	14-7/8"
Interior Depth (Top Unit)	22-3/4"
Height of Opening (Bottom Unit)	40-3/8"
Width of Opening (Bottom Unit)	14-7/8"
Interior Depth (Bottom Unit)	22-3/4"
P2484 24" W x 84"H x 24"D Pantry 4 Doors, 4 shelves	
Height of Opening (Top Unit)	32-7/8"
Width of Opening (Top Unit)	9-5/8"
Interior Depth (Top Unit)	22-3/4"
Height of Opening (Bottom Unit)	40-3/8"
Width of Opening (Bottom Unit)	9-5/8"
Interior Depth (Bottom Unit)	22-3/4"

96" HGT. PANTRY W ADJST. SHELVES



P1842T 18" x 42"x 24" Pantry Top Unit / 1 Door	
Height of Opening	38-7/8"
Width of Opening	14-7/8"
Interior Depth	22-3/4"
P1854B 18" x 54" x 24" Pantry Bottom Unit / 1 Door	
Height of Opening	46-3/8"
Width of Opening	14-7/8"
Interior Depth	22-3/4"

84" & 96" HGT. OVEN CABINET

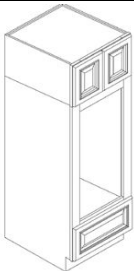

P3084OCD 30"W x 84"H x 24"D Oven Cabinet/2 Doors/1 Drawer	
Height of Upper Cabinet Opening	8-7/8"
Width of Upper Cabinet Opening	22-1/2"
Interior Upper Cabinet Depth	22-3/4"
Interior Drawers Width	20-7/8"
Interior Drawers Height	7-1/2"
Minimum Oven Cut out Width	22-1/2"
Maximum Oven Cut out Width	29"
Minimum Oven Cut out Height	49"
Maximum Oven Cut out Height	50-7/8"
P3096OCD 30"W x 96"H x 24"D Oven Cabinet/2 Doors/1 Drawer	
Height of Upper Cabinet Opening	20-7/8"
Width of Upper Cabinet Opening	22-1/2"
Interior Upper Cabinet Depth	22-3/4"
Interior Drawers Width	20-7/8"
Interior Drawers Height	7-1/2"
Minimum Oven Cut out Width	22-1/2"
Maximum Oven Cut out Width	29"
Minimum Oven Cut out Height	49"
Maximum Oven Cut out Height	50-7/8"

ACCESSORIES-FILLERS / MOLDINGS / PANELS

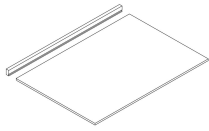

A30WF	3" x 30" Wall Filler (Reversible Plain or Decorative sides)	RV
A42WF	3" x 42" Wall Filler (Reversible Plain or Decorative sides)	RV
A30BF-RV	3" x 30" Base Filler (Reversible Plain or Decorative sides)	RV
A8TK	8 ft Toe Kick Plate	3 ea/pack
A8CM	Crown Moulding 8 ft length	3 ea/pack
A8BSM	Baseshoe Scribe Moulding 3/8"x3/4"x8ft	3 ea/pack
*Note: For TK, CM, & BSM must order master pack in quantities of (3)		
A24DEP	24"W x 34.5"H x 1.5"D Dishwasher End Panel	Avail
A1230WEP	12"W x 30" H Veneered Wall End Panel	Avail
A1242WEP	12"W x 42" H Veneered Wall End Panel	Avail
A2442WEP	24"W x 42" H Veneered Wall End Panel	Avail
A2435BEP	24"W x 35" H Veneered Base End Panel	Avail
A4834IBP	48"W x 34.5"H x 5 mm D Island Back Panel	Avail
A2496REP	24" x 96" x 1 1/2" Refrigerator End Panel	Avail

ACCESSORIES - VALANCES

A36VA	3" x 36" Straight Valance / Availability	Avail
A48VA	3" x 48" Straight Valance / Availability	Avail

ACCESSORIES - WINE GLASS HOLDERS

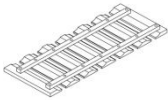

A30GH	30" W-Wine Glass Holder / Availability	Avail
	Number of Wine Glass Slots	6 slots
A36GH	36" W-Wine Glass Holder / Availability	Avail
	Number of Wine Glass Slots	7 slots

ACCESSORIES - ROLL OUT TRAYS

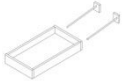

A15RT	Rollout Tray w/hardware for 15" Base / Availability	with Slides
A18RT	Rollout Tray w/hardware for 18" Base / Availability	with Slides

KITCHEN MERCHANDISING CENTER

2313KMC	22 3/4" x 17 1/2" x 13" Kitchen Merchandiser Center
---------	---

Finish Disclaimer: Please note that printed and electronic finish representations are intended to show the general pattern and color details of our finishes. Due to the natural variations in wood grain, finish application, printing, and monitor settings, we strongly recommend that you contact your dealer to see actual finish or product samples.